

INSTALLATION GUIDE (STANDARD INTERIOR WALL)

Recommended Additional Items:

- Level
- Tape measure
- Stud finder
- Drill
- Pencil
- Ladder
- French cleat mounting hardware

FOR ACTIVE WALLS

(active walls are considered areas where accessories will be changed often or rock holds used)

Recommended for classroom/gym/retail installations

Recommended to apply 1/2" plywood in place of drywall behind panels as backing/blocking. Panels can be secured by drilling screws straight into pin holes and into the back wall of plywood. This will keep your panels secure and level during active use of the myWall system.

myWall.



INSTALLING MYWALL TO STANDARD WALL

WARNING:

Prior to mounting french cleat onto wall, check for proper mounting anchors to use. (drywall, metal studs, wood studs, or concrete block will all need different hardware)

WARNING:

Recommended use of side locking plate on walls after installation of each individual panel (this ensures the safety of panel attaching securely to french cleat)

STEPS



1

Unpack boxes
(Ensure all parts are included for your wall installation)



2

Locate metal or wood stud locations on wall for mounting.

(Recommended use of a stud finder)

WARNING: Check for plumbing or electrical locations within wall.



3

Mark location for French Cleat.

French cleat height from floor to base of cleat can depend on use of panels.

Recommended height is **83.5 inches** from floor to **bottom** of french cleat.

(This will allow for wall plugs to be left exposed behind the lower panel for use)

(Ensure that French Cleat mounts level)

(Ensure to shim if needed for cleat to be perfectly flat on wall)



Secure French Cleat to desired location with correct mounting hardware.

Ensure that your cleat mounts level

(Correct mounting hardware will depend on overall wall structure used for mounting. Mount directly into wood studs, metal studs, concrete block etc.) (Do not mount into drywall only)

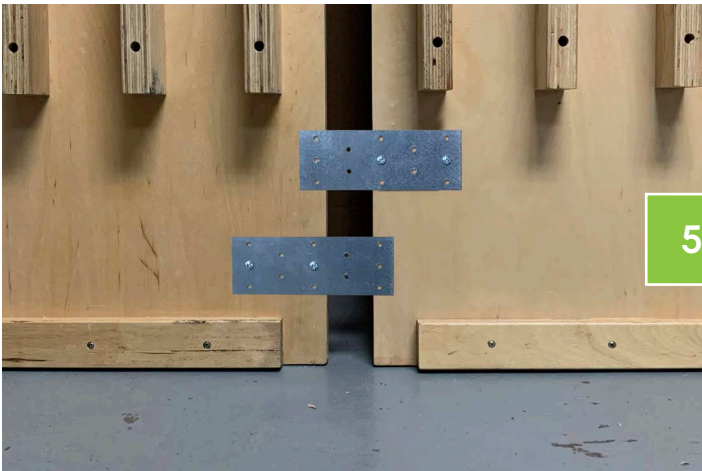

To ensure panels hang flush at bottom, attach flushing plates to back bottom of panels on sides, prior to hanging.

(Flushing plates are not necessary if you are drilling through peg holes to secure for active walls)

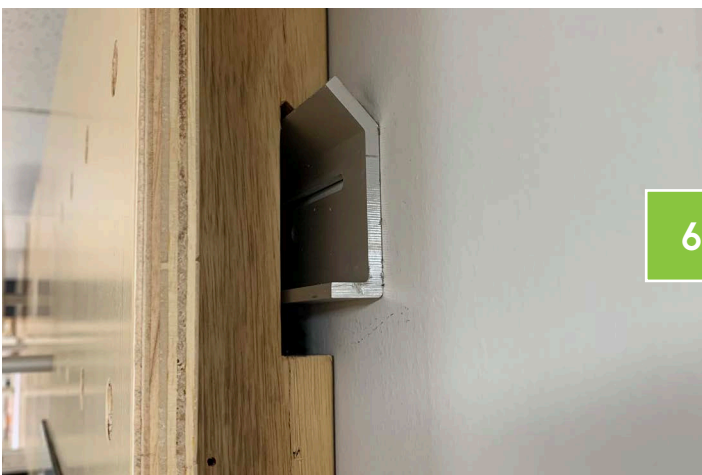

Hang panels on cleat

(mount locking plates as you go)

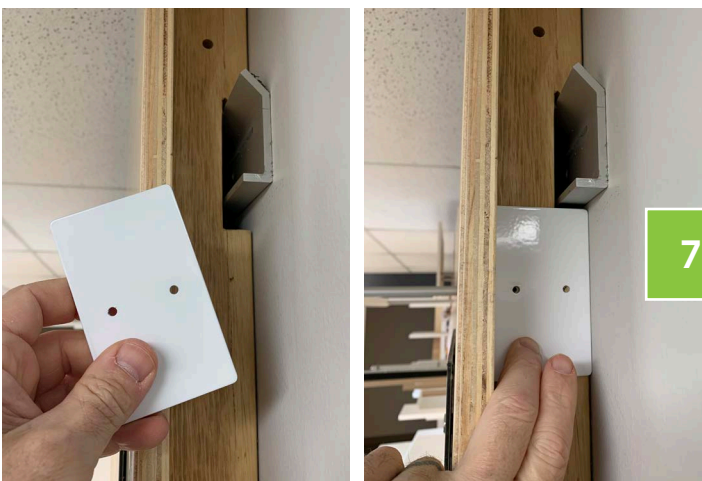

Attach safety locking plate to left or right side of mywall panels. This can be done as each panel is attached onto the wall.

(Recommended within overall installation)

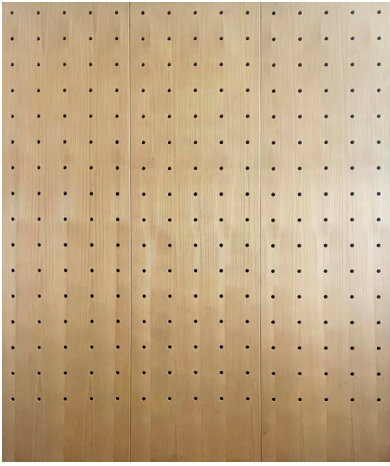

8

Ensure all panels are pushed together for a uniform fit.

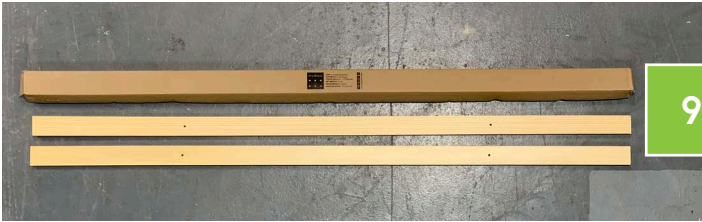

9

If end-caps came with your system, attach to outside edges with provided screws.

RENEWABLE RESOURCES

The myWall system utilizes Baltic birch, a highly sustainable and renewable resource. Sourced from fast-growing trees in responsibly managed Baltic forests, our plywood often carries FSC certification to ensure minimal environmental impact and ethical harvesting practices.

Re-use: Our products are durable and designed to last, cutting down the need to discard our products and purchase new ones.



myWall is a registered trademark and patented product.

All Rights Reserved.
©2026



adaptiv
DC

AdaptivDC
337 Victory Drive
Herndon, VA 20170

800. 693. 0068
info@adaptivdc.com
www.mywallpro.com