

myWall.



MYWALL PANEL SPECIFICATIONS

myWall.

SAMPLE IMAGES

myWall panels are available in standard whitewash or natural colors. (custom colors available upon request)



myWall.

HOW THE SYSTEM WORKS

Pins are available in either locking or non-locking versions.

myWall locking pin system

This patented wall system allows users to construct large display areas with massive load capabilities and premium visual appeal.

With the use of locking pins, the structure becomes a safe display surface for multiple objects or display items.



FIRE RATED

Provided by: HPVA Labs (Baltimore Maryland)
Class B

MATERIALS

Rubber wood / Para wood (Thailand)
Renewable Resource

WEIGHT LOAD LIMITS

Provided by: NTS (Baltimore Maryland)
Load limit weight tested to beginning of deflection

Panel - 4,939 lbs.
Locking Pin - 443 lbs.
Non-locking Pin - 328 lbs.
Shelf (non-locking pins) - 1,017 lbs.

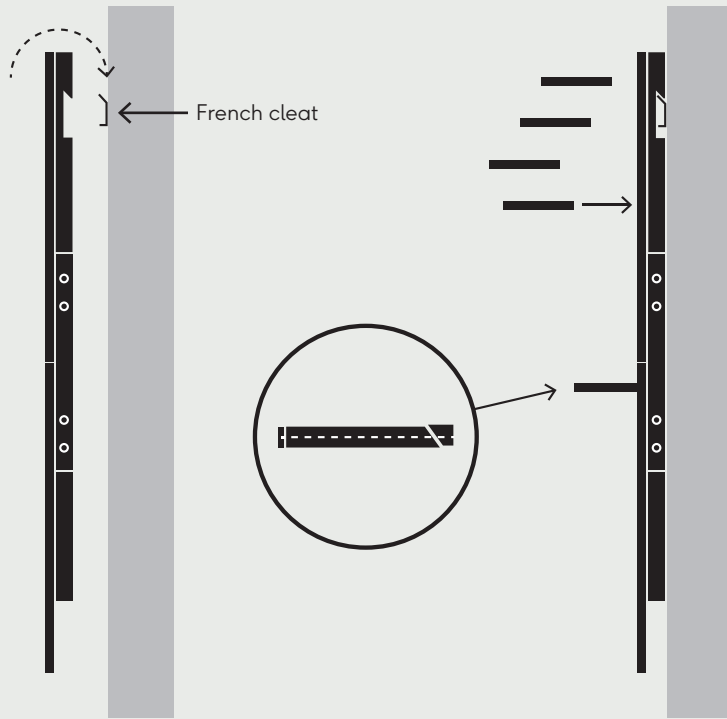
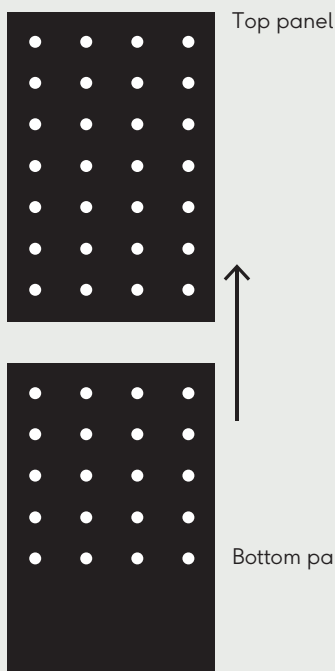

PANEL SPECIFICATIONS

23.6"



85"



FRONT

BACK

GENERAL PRODUCT SPECS:

- Height: 2160mm (85.03")
- Width: 600mm (23.6")
- Depth: 72mm (2.8")
- Pin Hole Diameter: 16.3mm
- Pin Hole Depth: 38mm
- Weight: 23 kilogram
- Distance between holes: 120mm

Back of myWall detail



French cleat section



RENEWABLE RESOURCES

The myWall system uses rubber wood, a renewable and sustainable byproduct of the latex industry.

Reduce: We work with our manufacturing partners to ensure we are leaving as small a carbon footprint as possible.

Re-use: Our products are durable and designed to last, cutting down the need to discard our products and purchase new ones.

Recycle: Our products and components use recyclable materials.



myWall is a registered trademark and patented design of Thinkterior Studio Pte Ltd, Thailand.

All Rights Reserved.
©2021

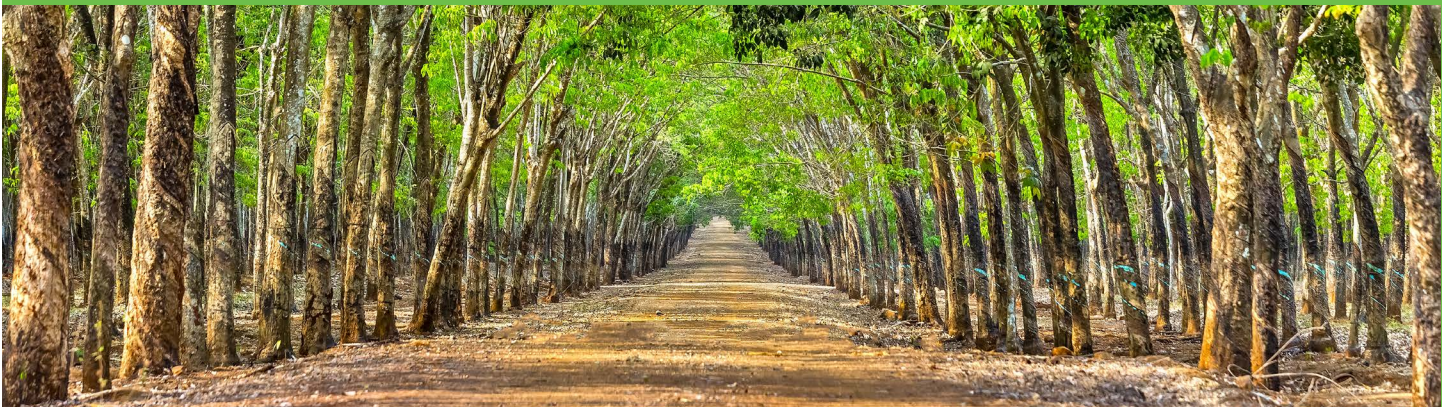

adaptiv
DC

AdaptivDC
42395 Ryan Road
Suite 112 / PMB 212
Ashburn, VA 20148

800. 693. 0068
hello@adaptivdc.com
adaptivdc.com